

Addendum No. 1

2009 Washoe Flume Rehabilitation

Bid # 0910-112
September 17, 2009

The following information, clarifications, changes and modifications are by reference incorporated into the bid documents for the above referenced project. Any work item or contract provision not changed or modified will remain in full force and effect. The bid date and time and construction schedule remain the same.

1. The nail pattern for the knee braces has been revised per the attached Figure 01. A similar pattern of six nails is to be used for the top connection to the post. Add the attached Figure to the bid drawings.
2. The Bid Schedule and Bid Item Description have been modified per the attached sheets. Bid Item 4 has been added as shown. Replace the originally provided documents with the attached documents.

Question Received:

3. Are all of the accessories for the whaler rods supplied by TMWA or do they fall into the "All other material.....supplied by the contractor" category? Are the Post Tie Rods and Material w/accessories supplied by TMWA or do they fall into the "All other material..... supplied by the contractor" category??

TMWA will provide all lumber and whaler rods only. TMWA will not provide whaler rod hardware, nuts, washers, post tie rods, nails or another material or fasteners. The contractor is to provide all material, hardware, and accessories required to complete the project except lumber and whaler rods.

Attachments:

Figure 01
Bid Item Descriptions
Bid Schedule page BS-2

End of Addendum No. 1

2X6 KNEE
BRACE

30d (0.192"X4 $\frac{1}{4}$ ")
SINKERS. SIX
TOTAL SPACED AS
SHOWN.

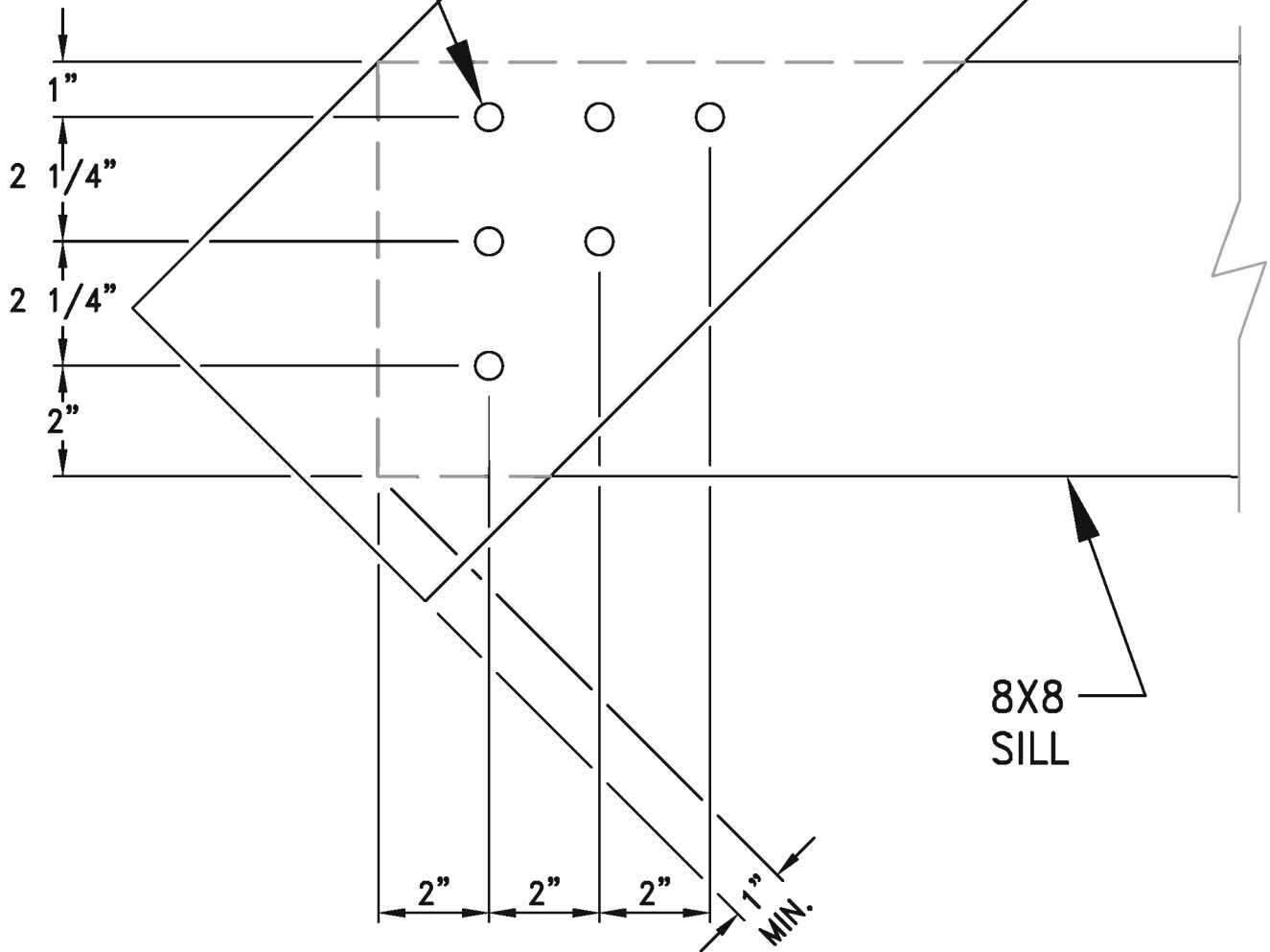

8X8
SILL

2009 WASHOE FLUME REHAB
ADDENDUM #1
KNEE BRACE NAIL PATTERN

DATE:	09/17/09
DRAWN BY:	HCS
WORK ORDER #:	06-007
SCALE:	NTS

FIGURE
01

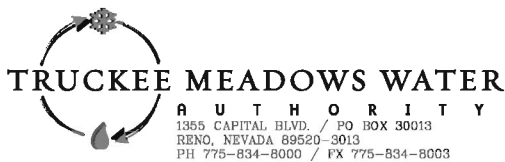

BID ITEM DESCRIPTION
2009 Washoe Flume Rebuild
TMWA Project No. 06-007

Bid Item Number 1

This item is to include only items necessary and preliminary to performance of the work. Obviously unbalanced bids may be considered to be unresponsive. See Section 7.01 of the General Conditions for details.

Bid Item Number 2

This item entails the rehabilitation of 37 box structures on the Washoe Flume. "Rehabilitation" is defined as the removal of existing flume box components including end posts and sills, and the reinstallation of new side boards (2"x12"x16'), floorboards (2"x12"x16'), installation of longitudinal whalers at the bottom of the flume (6"x6"x16'), installation of PVC liner, then plywood for sidewalls and flume floor, and batten strips for securing plywood to side boards. Some boxes may require leveling of posts and box structures. All lumber and whaler rod material for this bid item will be provided by TMWA. Contractor will transport lumber and whaler material from TMWA's Verdi storage yard to the job site. Contractor will provide all other material, including PVC liner, nails as specified by TMWA, staples, miscellaneous hardware and supplies as necessary to complete the project, and will perform the Work according to the "Flume Box Rehabilitation Construction Standards", provided.

Bid Item Number 3

This item entails the rehabilitation and leveling of 7 flume boxes on the Washoe Flume. Rehabilitation is identical to that described in bid item number two, except that the existing caps and walk boards will be salvaged and reused.

Bid Item Number 4

This item entails the removal and replacement of caps in areas of the flume that are not being rehabilitated. Existing caps and hardware are to be removed and disposed of, and new caps provided by TMWA are to be installed in their place. Walk boards are to remain. All cap straps are to be provided by the contractor. Any post repair straps are to be salvaged and returned to TMWA.

Bid Item Number 5

This is the numerical sum of the prices for bid items one through four.

BID SCHEDULE

September 17, 2009

NOTICE: No substitution or revision to this Bid Schedule form will be accepted. Truckee Meadows Water Authority will reject any Bid that is received that has changes or alterations to this document. Although the Prevailing Wages are provided in this bid document, the bidder is responsible to verify with the Labor Commissioner if any addendums have been issued. If different, the successful bidder will be required to provide the current Prevailing Wages used in preparation of their bid within 24 hours of bid submission.

BID # 0910-112

BID TITLE: 2009 Washoe Flume Rehabilitation

PRICES must be valid for 30 calendar days after the bid opening.

A COPY OF THE "CERTIFICATE" of eligibility to receive a preference in bidding on public works issued to him/her by the State Contractors' Board must be submitted with his/her bid to the Contracts Division in accordance with N.R.S. 338.147 for the preference to be considered. This Statute does not apply to projects expected to cost less than \$250,000.

COMPLETION of this project is expected **PURSUANT TO CONTRACT DOCUMENTS**.

BIDDER acknowledges receipt of _____ Addendums.

(signature)

SUMMARY

This Project is bid on a per item lump sum basis and shall include all necessary appurtenances for a complete in-place, functional facility. Prices shall include all labor, equipment, hardware materials, supervision, profit, overhead, and incidental costs. Bidder proposes to complete the Work for the following prices:

Description	Scheduled Value	Unit	Unit Price	Total Price
1. Mobilization/Demobilization, Insurance, Bonds, Testing, Site Cleanup, and Miscellaneous Fees.	1	LS	Lump Sum	
2. Furnish Labor, Equipment and Hardware to Rehabilitate and Level 37 Flume Boxes on the Washoe Hydroelectric Flume Including Caps and Walk Boards (Boxes 1-8, 99-117, 137-146)	37	EA Box		
3. Furnish Labor, Equipment and Hardware to Rehabilitate and Level 7 Flume Boxes on the Washoe Hydroelectric Flume Excluding Caps and Walk Boards (Boxes 147-153)	7	EA Box		
4. Removal of existing cap and replacement with a new TMWA-provided cap. Contractor to provide cap straps and nails.	30	EA		
5. TOTAL BID PRICE				

Total Bid Price Written in Words: _____

Notes to Bid Schedule:

- Item pricing on this schedule is for use in preparing the schedule of values that will be used as a basis for partial payments during construction and for internal TMWA use. Item descriptions are not intended to be all inclusive. Bidders shall include costs for work not specifically mentioned in the most appropriate item.
- Refer to "Bid Item Clarification" section of the bid documents for clear definition of each bid item.
- TMWA reserves the right to perform extra work using either time and expense, or negotiated lump sum procedures.
- The Contract Sum will be adjusted (increased or decreased) for actual quantities per the unit price items. Lump sum items will not be adjusted.
- TMWA will provide all lumber and whaler materials for this project. Contractor will provide all other material (PVC liner, nails, staples, etc.)
- Due to Budget and Schedule Constraints, TMWA reserves the right to accept bids whole or in part.