

NOTES:

1. CONCRETE COLLAR SHALL BE MINIMUM 6-INCHES THICK OR MATCH PAVEMENT THICKNESS, WHICHEVER IS GREATER, UNLESS OTHERWISE SPECIFIED BY THE JURISDICTIONAL AGENCY RESPONSIBLE FOR THE ROADWAY.
2. FOR MULTIPLE VALVE/RISER BOXES IN CLOSE PROXIMITY, A MONOLITHIC CONCRETE COLLAR MAY BE POURED.
3. CONTRACTOR AND/OR DESIGN ENGINEER SHALL CONSULT WITH THE JURISDICTIONAL AGENCY RESPONSIBLE FOR THE ROADWAY FOR REQUIREMENTS THAT MAY VARY FROM THIS STANDARD PRIOR TO CONSTRUCTION.
4. ALL BOLTS AND EXPOSED METAL SHALL BE COATED WITH BRUSHED-ON MASTIC.
5. GATE VALVE, DUCTILE IRON PIPE, AND OTHER METAL PARTS SHALL BE ENCASED WITH POLYETHYLENE WRAP PER AWWA C105.
6. UNLESS OTHERWISE SPECIFIED BY THE JURISDICTIONAL AGENCY RESPONSIBLE FOR THE ROADWAY, PORTLAND CEMENT CONCRETE (P.C.C.) FOR CONCRETE COLLAR SHALL HAVE THE FOLLOWING CHARACTERISTICS: 4,000 PSI MINIMUM COMPRESSIVE STRENGTH AT 28 DAYS, MINIMUM 6 SACKS OF CEMENT PER CUBIC YARD WITH A MAXIMUM WATER/CEMENT RATIO OF 0.45, AIR ENTRAINMENT 6% ±1.5%, SLUMP AT 1 TO 4 INCHES. BAG CONCRETE MIX IS NOT ACCEPTABLE.
7. CONCRETE FOR PAD SHALL HAVE A COMPRESSIVE STRENGTH OF NOT LESS THAN 3,000 PSI AFTER 28 DAYS. BAG CONCRETE MIX IS NOT ACCEPTABLE.

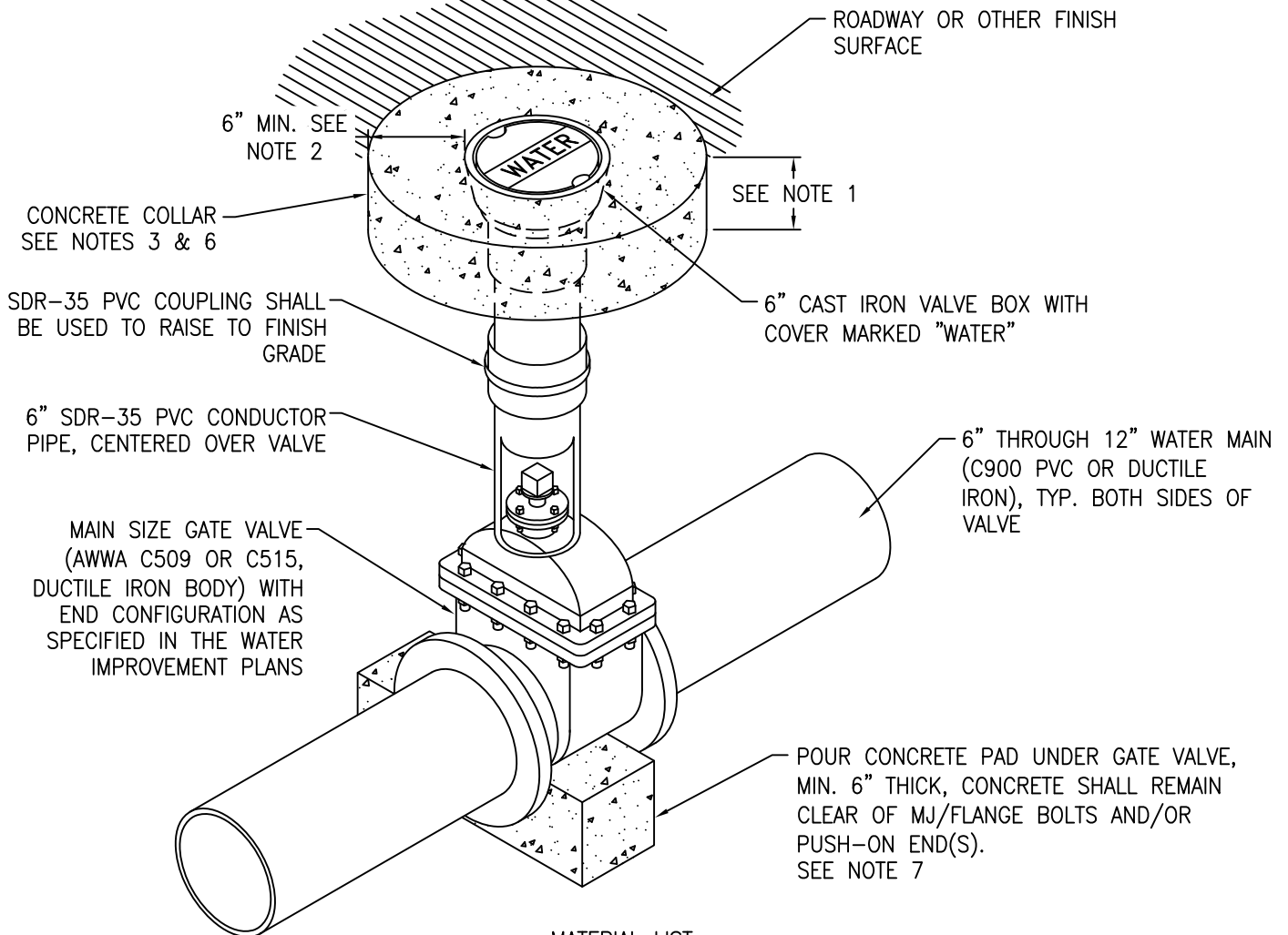

MATERIAL LIST

QTY	DESCRIPTION
1	MAIN SIZE GATE VALVE (AWWA C509 OR C515, DUCTILE IRON BODY) WITH END CONFIGURATION AS SPECIFIED IN THE WATER IMPROVEMENT PLANS
1	MASTIC (1 GALLON CAN - BRUSH ON)
1	6" Ø SDR-35 PVC CONDUCTOR PIPE SECTION
1	6" Ø CAST IRON VALVE BOX WITH COVER MARKED "WATER"
1	FULL FACE GASKET
1	CONCRETE BULK - PAD AND COLLAR



DATE
1/2002
REV
7/2011

APPENDIX 10J
DISTRIBUTION VALVE INSTALLATION
IN-LINE GATE VALVE
WITH CONCRETE COLLAR

DRAWING NUMBER
10J-2