

Addendum No. 4

TANK ACCESS ROAD IMPROVEMENTS

PWP Bid No.: WA-2019-070
TMWA Capital Project No.: 14-0015
January 4, 2019

The following information, clarifications, changes and modifications are by reference incorporated into the bid documents for the above referenced project. Any work item or contract provision not changed or modified will remain in full force and effect.

Bid Due Date is Wednesday, January 9, 2019 at 10:00am.

QUESTIONS

Upon inspection of the FEMA Site 11-Spring Creek 6 Tank (Donavon Tank) we have the following questions:

1. Could you please provide a detail for the ditch reconstruction.
1. **Response:** A detail specifically for riprapped ditch reconstruction was not included in the Improvement Plans since dimensions and rock size may vary by site, but it most-closely resembles A/D1 without the geotextile. The reconstructed cross section should closely approximate the original ditch cross section to prevent net import or export of riprap.
2. The existing rock appears to be a class 400 type rock which is currently placed as slope protection on both sides of the road. Is the intent to remove rock along road, shape ditch sections, and place existing rock back? If so the new ditch detail shown in the plans may not accommodate the larger rock? On the downhill slope it would require fill to build the ditch. Could extra dirt be placed on downhill side if needed or would some export be possible?
2. **Response:** Yes, the intent is to remove, screen, and reuse the existing rock. Since the original ditch was constructed with the existing rock on site, it is expected that the reconstructed ditch will accept it without significant effort to reshape or resize the ditch. Excess dirt as a result of the Work can be "lost" on site downhill side as long as unsuitable material such as trash and vegetation are removed and disposed of. Any significant change to the Work will be considered as "Extra Work" per Article 7 of the General Conditions.
3. Additionally, would there be fabric placed under the rock?
3. **Response:** The bid item for riprap ditch reconstruction does not call for geotextile fabric.

CLARIFICATION AND CORRECTION

The road with indicated in Note 1 on Sheet C9 of the Improvement Plans is incorrect. The note has been corrected, and the revised sheet is attached. Bidders are directed to remove Sheet C9 from the Bid Set and replace it with the attached, corrected sheet.

END OF ADDENDUM NO.:4

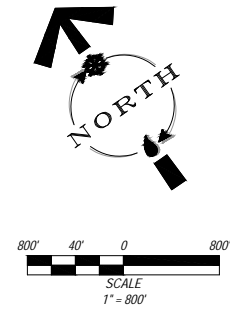

NOTES:

- ① RE-GRADE 22,000 LF X 10' WIDE ACCESS ROAD.

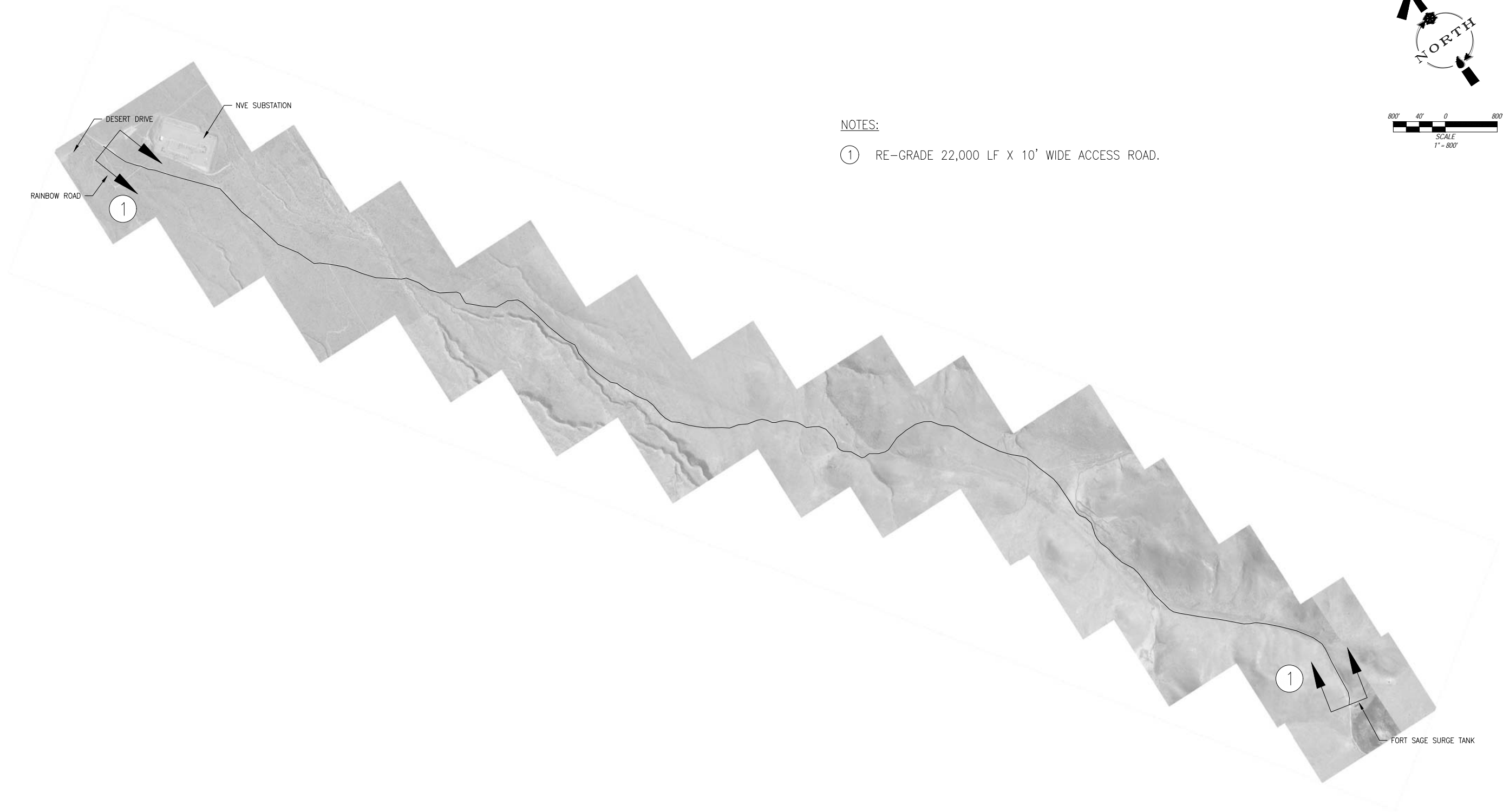

BID SET
NOT FOR CONSTRUCTION
JANUARY 2019

K:\2018\17_Capital Projects\14-0015 Access Road Improvements\CAD\14-0015 C1-CX SITES.dwg
Jan 02, 2019 4:16pm

REVISION	DESCRIPTION	BY	APP	DATE

WORK ORDER NO. 14-0015
 DESIGNED HCS
 DRAWN JRH
 DATE NOV, 2018
 CHECKED _____
 SUBMITTED _____
 RECOMMENDED _____
 APPROVED _____

TRUCKEE MEADOWS WATER AUTHORITY
Quality. Delivered.
 1355 CAPITAL BLVD. PO BOX 30013 RENO, NEVADA 89520-3013 PHONE: 775-834-8080

NOT REPRODUCIBLE
 PROPERTY OF TRUCKEE MEADOWS WATER AUTHORITY, RETURN UPON COMPLETION OF PROJECT (Per Homeland Security Act)

ACCESS ROAD IMPROVEMENTS
WASHOE COUNTY, NEVADA
FEMA SITE 14 - VIDLER ACCESS ROAD
FORT SAGE SURGE TANK

H. CHRIS STRUFFERT
 CIVIL
 No. 13113
 01.03.19

SHEET NUMBER
C9
 11 OF 12