

COMMERCIAL PROJECT EXAMPLE FIRE APPROVAL

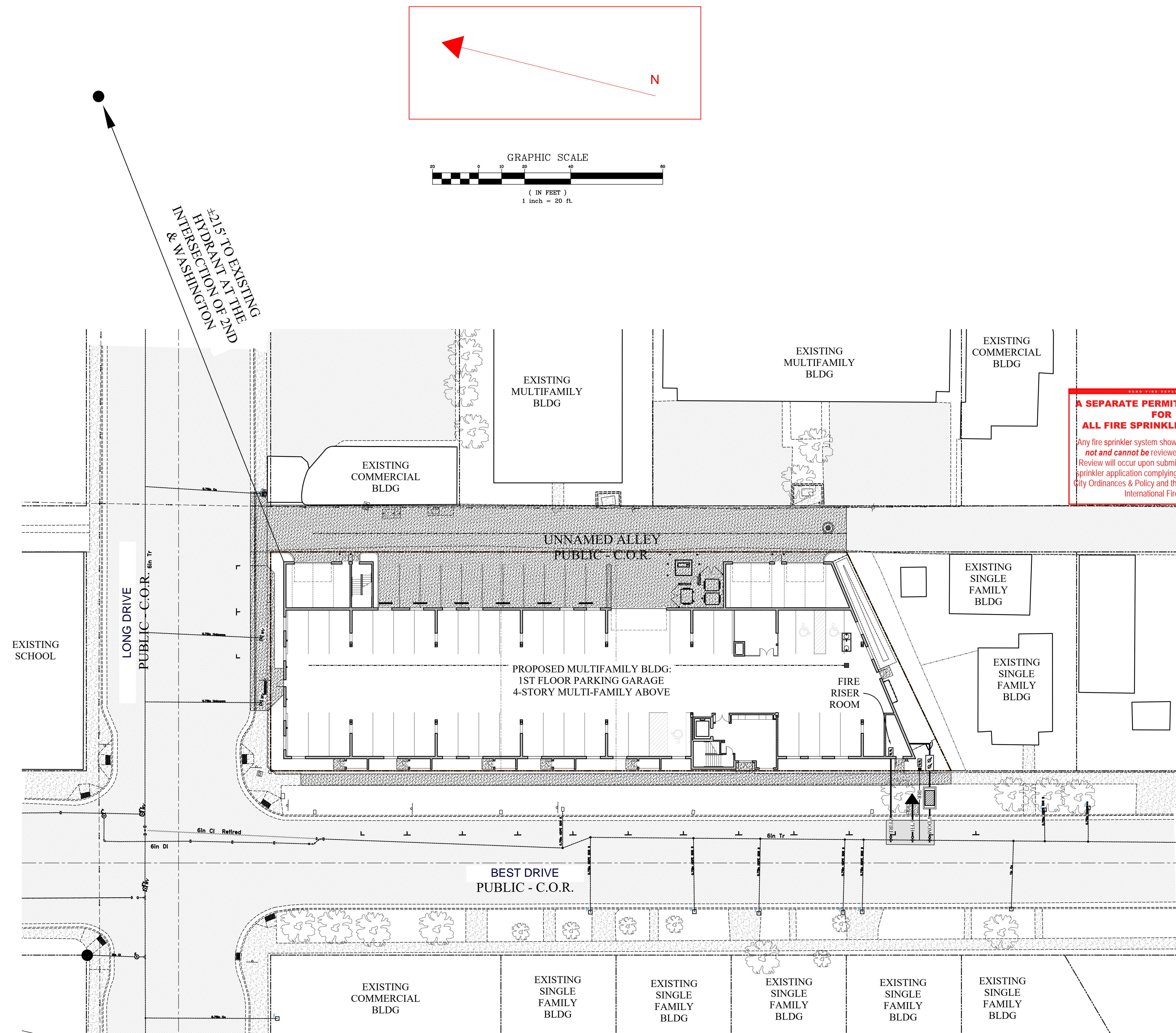

**A SEPARATE PERMIT IS REQUIRED
FOR
ALL FIRE SPRINKLER SYSTEMS!**

Any fire sprinkler system shown on these plans **has not and cannot be** reviewed at this time. Plan Review will occur upon submittal of a separate fire sprinkler application complying with NFPA 13, Reno City Ordinances & Policy and the current edition of the International Fire Code

APPROVED
FIRE MARSHAL
Nick Manzo
RENO FIRE DEPARTMENT
DATE: **January 26, 2022**

FIRE FLOW CALCULATIONS - 126 WINTER ST

FIRE FLOW REQUIREMENT IS 2,750 GALLONS PER MINUTE
@ 20psi RESIDUAL PRESSURE FOR 2 HOUR.

BASED ON:

SQUARE FOOTAGE: 93,896 SQUARE FEET
LARGEST AREA BETWEEN 4 HOUR
AREA SEPARATION WALLS: 93,896 SQUARE FEET
BUILDING HEIGHT: 55 FEET
NUMBER OF STORIES: PARKING GARAGE + 4 FLOORS
TYPE OF CONSTRUCTION: V-A
OCCUPANCY: R-2
FULL AUTOMATIC FIRE SPRINKLER SYSTEM: x YES NO
REVIEWED BY: _____ DATE: _____
RENO FIRE DEPARTMENT

Prior to storage of Combustibles and/or framing on site, the applicant shall install fire hydrants with adequate flows for fire fighting purposes, as per approved plans and the satisfaction of the Reno Fire Department.

IFC 2018 sec.3312

SITE INFO:
123 BEST DRIVE

FIRE HYDRANT NOTE:
CURBS AT FIRE HYDRANTS SHALL BE PAINTED RED FOR 15.00', CENTERED AT THE FIRE HYDRANT, PER THE CITY OF RENO DESIGN MANUAL.

LEGEND:

● EXISTING FIRE HYDRANT

▲ PROPOSED FIRE HYDRANT

DATE: 12-6-21

DRAWN BY: ACAD2020

DESIGNED BY:

CHECKED BY:

RENO

WASHOE COUNTY

NEVADA

FIRE HYDRANT APPROVAL PLAN

123 BEST DRIVE

SCALE

HORIZ. 1"=20'

VERT. ----

JOB NO. ----

SHEET

F-1

OF

1

RESIDENTIAL EXAMPLE FIRE APPROVAL

(FIRE HYDRANT PLAN)
WONDERFUL VILLAGE PHASE 4

WASHOE COUNTY NEVADA
JANUARY, 2021

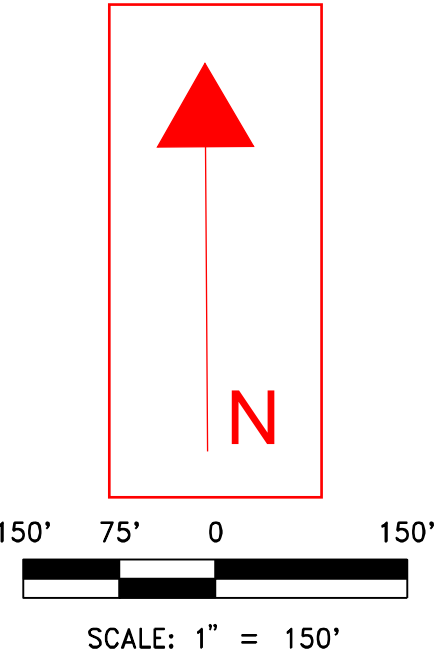

FIRE FLOW CALCULATIONS

STANDARD FLOW REQUIREMENT:
FIRE FLOW REQUIREMENT IS 1,750 GALLONS PER MINUTE @ 20 PSI RESIDUAL PRESSURE FOR 2 HOURS.

50% REDUCTION DUE TO FIRE SPRINKLERS:
FIRE FLOW REQUIREMENT IS 875 GALLONS PER MINUTE @ 20 PSI RESIDUAL PRESSURE FOR 2 HOURS.

WATER SYSTEM IS DESIGNED FOR 1,500 GALLONS PER MINUTE @ 20 PSI RESIDUAL PRESSURE FOR 2 HOURS.

BASED ON:

SQUARE FOOTAGE: 3,600 TO 4,800 SQUARE FEET

LARGEST AREA BETWEEN 4 HOUR AREA SEPARATION WALLS: N/A SQUARE FEET

BUILDING HEIGHT: 30 FEET

NUMBER OF STORIES: 2 FLOORS

TYPE OF CONSTRUCTION: V-B

OCCUPANCY: R-3

FULL AUTOMATIC FIRE SPRINKLER SYSTEM: ☒ YES ☐ NO

10

WONDERFUL VILLAGE PHASE 4

WONDERFUL VILLAGE PHASE 2

